



Ravenscroft  
Primary School

# Returning to school on 8<sup>th</sup> March

## Nursery AM FACTSHEET

**ALL ADULTS MUST WEAR A MASK ON SCHOOL PREMISES**

**Timings and procedures for dropping off and picking up your child.**

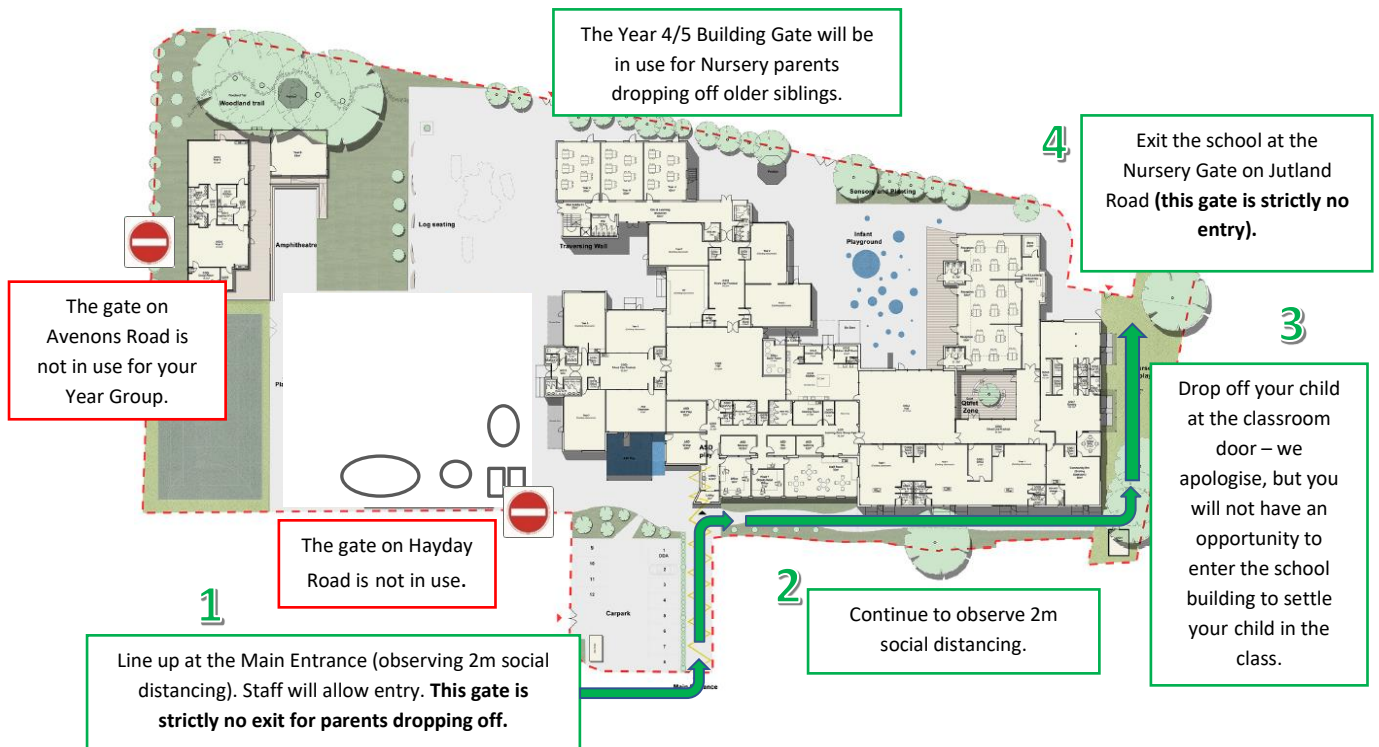

**Arrival time for Nursery AM pupils is 8.30am**

It's really important that you arrive on time – **not too early and not too late** – as other Year Groups will be lining up to enter the school before and after you.

**Entrance is strictly by the Main Gate on Carson Road only – please socially distance when queuing.**

Staff will be on hand to support you in walking around the building to the right place and then to leave the premises by the correct gate. This is in order to maintain a one-way system and keep to social distancing.

Please remember, it won't be possible to speak to your child's class teacher at this point – we need to get pupils into the classrooms as soon as possible and keep the flow of arrivals moving quickly and smoothly.

Pupils should wear school uniform (or PE kit on their PE days), and bring to school the minimum of personal belongings – e.g. their reading book in a bag and a labelled water bottle.

**Pick-up time for Nursery pupils is 11.30am**

For those parents with more than one child at the school – you now have the option of dropping all of your children at the same time (at the time of your youngest child). **Pupils must be picked up at the correct time at the end of the day.** Older pupils who do not usually come to school with their siblings, or who travel independently, must continue to arrive at school at their normal time. If your child's sibling is in Year 1, please drop off them on your way to Nursery, if they are in an older Year Group, please drop them off after.