

INFORMATION FOR PARENTS OF NURSERY AM PUPILS

Pupil drop off/pick up – from Wednesday 3rd June

Nursery AM 8.45am – 11.15am

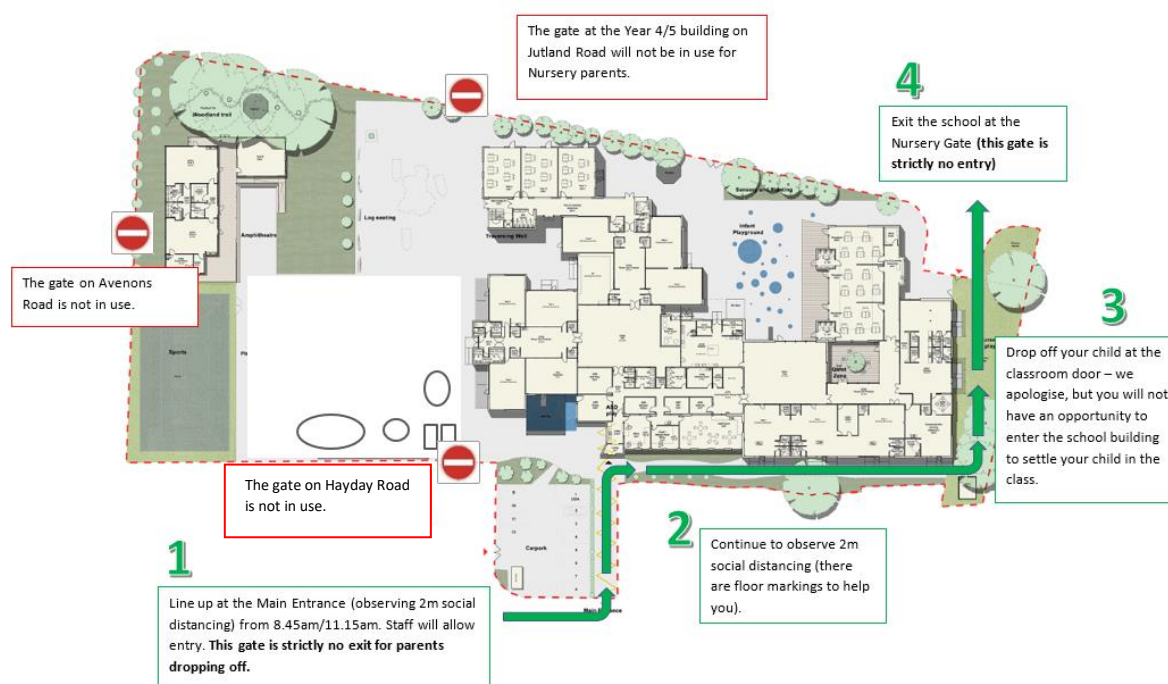

Pupils in different year groups have staggered arrival and departure times.

Pupils who attend the morning Nursery session should:

1. Arrive at the main gate on Carson Road at **8.45am**. Pupils should be brought by one adult and should respect social distancing outside of the school gate when queuing up to enter – signage will be displayed on the school fence.
2. A member of staff will allow parents and pupils to enter the school site intermittently to allow for social distancing, and this should continue as they walk around the school site to the Nursery Classroom doors. Signage will be displayed on the paths.
3. Parents should drop off their child at the Nursery Classroom door – unfortunately, we will not be able to let any parents into the building to settle their child in the class.
4. Parents should then exit the school at the Nursery Gate **this gate is strictly no entry**.

Pupils will be encouraged to wash/sanitise their hands immediately on entry to their classroom.

Pupils must be picked up from school at **11.15am**. Parents should follow the same procedure as above to pick up their child.

This will allow time for thorough cleaning of Nursery Classrooms before the afternoon session.

Pupils must wear fresh clothes every day to mitigate the risk of transmission of the virus; however they do not need to wear school uniform. Shoes suitable for PE should be worn.